

# INCOPLAS™ LED Hybrid USER GUIDE

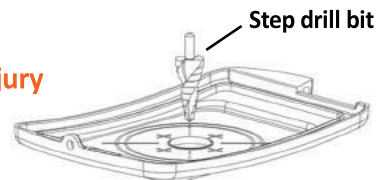

**READ CAREFULLY BEFORE INSTALLING FIXTURE. RETAIN THESE INSTRUCTIONS FOR FUTURE REFERENCE.** Must be wired in accordance with the National Electrical Code and all applicable local codes. **THIS PRODUCT MUST BE INSTALLED IN ACCORDANCE WITH THE APPLICABLE INSTALLATION CODE BY A PERSON FAMILIAR WITH THE CONSTRUCTION AND OPERATION OF THE PRODUCT AND THE HAZARDS INVOLVED. WARNING: Make certain power is OFF before installing or maintaining fixture. No user serviceable parts inside.**

**IMPORTANT NOTE: When drilling large holes for cable glands in the plastic J-box, it is HIGHLY RECOMMENDED to use a step drill bit or unibit to lessen the chances of personal injury or damage to the fixture.**



Determine the method of mounting.

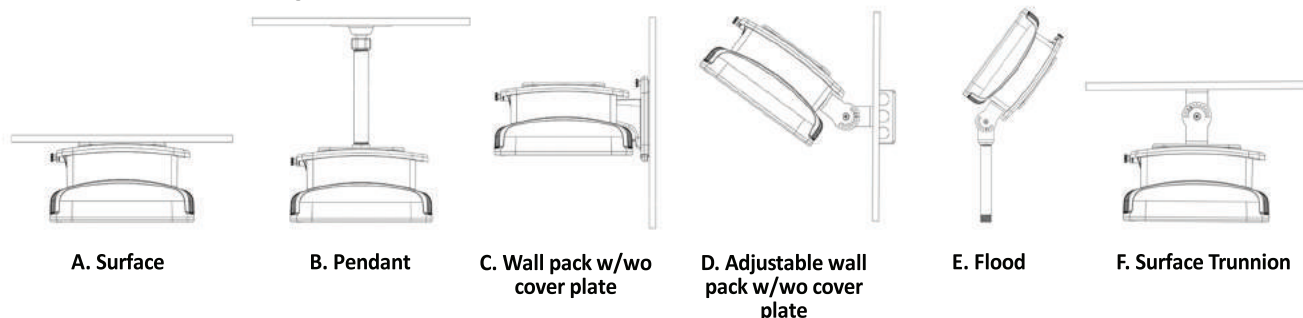

\*Installation of optional occupancy and photo cell located at end of this installation guide.

*When mounting fixture to either junction cover or wall pack brackets hinge pin, be careful not to knock fixture off hinge when wiring. LOCKING THUMBSCREW IS STANDARD 1/4X20 THREAD. ANY 1/4X20 BOLT WILL WORK.*

## WIRING INSTRUCTIONS

Black and white wires on one side of driver are the Power Input wires: 1. Black=120-277V 2. White=Neutral/Common 3. Green and Yellow=Ground **DIMMING** 4. Purple=Positive 5. Gray=Negative 6. Orange=Not Used

### A. SURFACE MOUNT

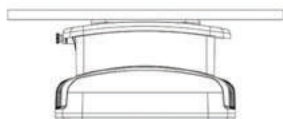

*Note: Surface mounting the fixture directly to a J-box will require an appropriate gasket material (not supplied) to be used between the plastic junction box top of the fixture and the AC supply J-box. Alternatively, a bead of waterproof silicone caulking (not supplied) can be used to seal around mating surfaces.*

1. Remove the thumbscrew and remove junction box top from the fixture.
2. Determine screw mounting locations. Drill mounting holes in the plastic fixture junction box top at the appropriate points. Drill an access hole in the junction box top to allow for routing branch wire power. Secure the fixture junction box top to the AC supply J-box in the desired mounting position using the appropriate mounting screws with washers (not supplied) being sure to follow all UL, NEC, and minimum load ratings guidelines.
3. Connect the fixture to the mounted lid and let hang to facilitate wiring. **See wiring instructions above.**
4. Close the fixture taking care to ensure all wires are inside junction box and the junction box is seated properly on the gasket. Push the fixture upward to compress the gasket and install the 1/4 x 20 black nylon thumbscrew and tighten.

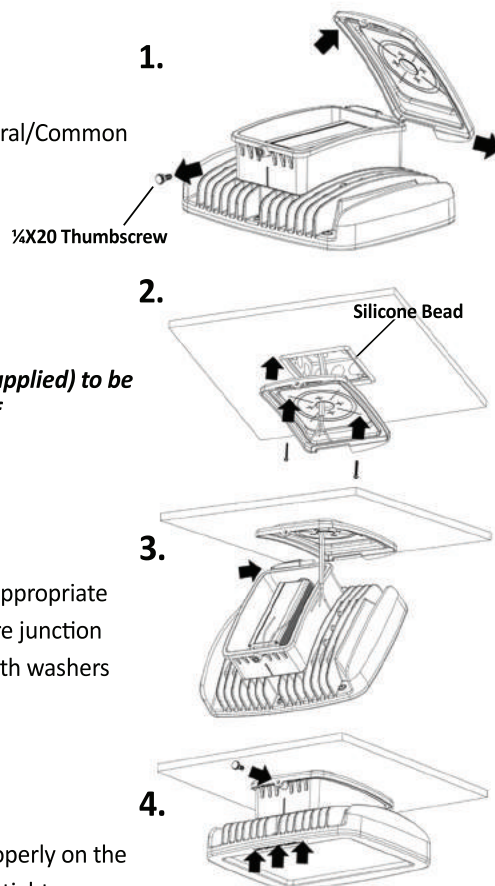

## B. PENDANT MOUNT

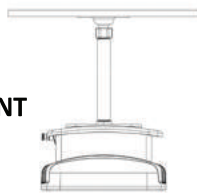

Use  $\frac{3}{4}$ " NPT (1" outer diameter) fixture conduit stem threaded on both sides, wire of desired length and a commercial flexible fixture hanger or swivel hanger. Other pendant mounting systems can be used. Determine if mounting pipe and hardware is rated for the application environment.

1. Position the hanging pendant mounting termination at the desired location and feed the AC supply wires through the end of the pendant.
2. Remove lid from fixture.
3. Drill the appropriate size hole in the center of the top of the black plastic junction box to accommodate the pendant mounting hardware (**Use step drill bit**). Secure the junction box top to the pendant mount in the desired mounting position. Use watertight connector or silicone caulking to completely seal the pendant connection to the junction box to ensure a weatherproof installation.
4. Mount the fixture to the mounted lid and let hang to facilitate wiring. **See wiring instructions above.**
5. Close the fixture, taking care to ensure all wires are inside junction box. Push the fixture upward to compress the gasket and install the  $\frac{1}{4}$  x 20 black nylon thumbscrew and tighten.

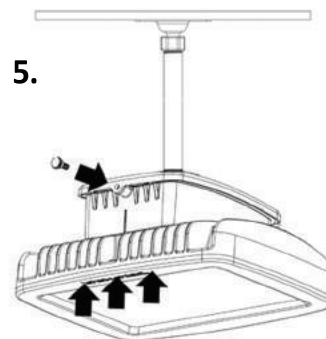
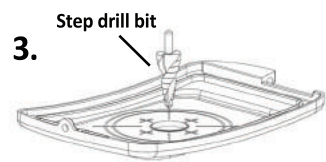
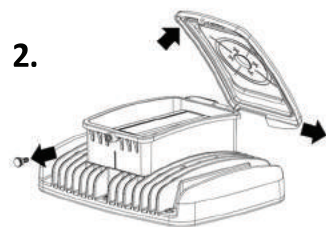

## C. WALL PACK MOUNT WITH/WITHOUT OPTIONAL MOUNTING COVER

*\*Optional wall pack mounting cover will mask area of removed old wall pack.*

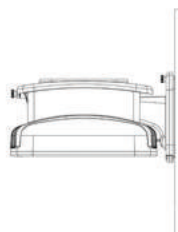

### Installation instructions for mounting wall pack bracket to LED Hybrid Fixture.

1. Drill two  $\frac{3}{16}$ " holes in driver box on both sides of the center line. Center points of drill locations are on the top of the lines.
2. Drill .875" hole using a step drill or unibit using the top of the middle line as a drill center point.
3. Assemble the wall pack bracket onto the fixture driver box with the (2) supplied  $\frac{5}{32}$  x 1.75" long bolts. Secure bolts on inside of driver box using supplied washers and nylon locking nut. Secure tightly. **SEE FIGURE C3**

**NOTE: If replacing existing wall pack and optional wall pack cover plate is NOT used, proceed to Step 8.**

4. Position optional mounting plate to cover footprint from original removed wall pack and determine mounting holes and drill for mounting hardware (not supplied). Make sure the mounting plate hole locations are drilled to a strong support of the building to support the weight of the fixture.
5. Drill hole to allow for wiring to pass through using step drill in center area of plastic optional mounting cover plate to allow access to wires.
6. Mount the cover plate on to the building and use watertight silicone caulking to completely seal the mounting plate where it meets the surface to ensure a weatherproof installation. **SEE FIGURE 9 ON NEXT PAGE.**
7. Route building power wires through wall pack mounting plate hole.
8. Remove the thumbscrew from the wall pack mounting bracket and remove the mounting plate from the fixture.

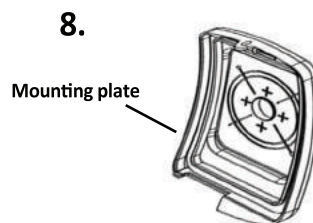
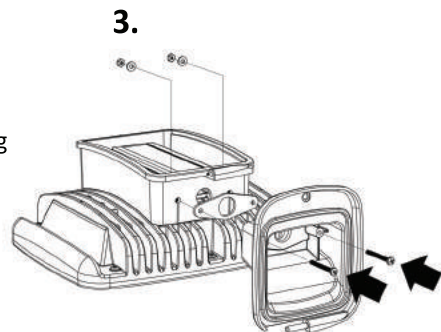
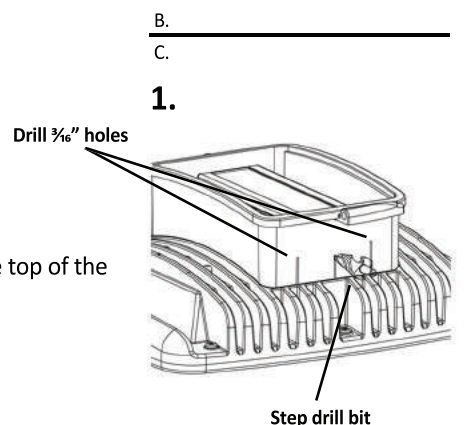

9. Mark and drill screw mounting location and drill holes in the plastic fixture wall pack mounting plate. Use watertight silicone caulking to completely seal the mounting plate where it meets the surface to ensure a weatherproof installation. Secure the mounting plate to the wall J-box or optional mounting cover plate using the appropriate mounting screws with washers (not supplied). Adjust mounting plate using installed level and secure mounting plate.

10. Mount the fixture to the mounting plate and let hang to facilitate wiring.

11. Remove the thumbscrew from the fixture top and open to access wires. Feed the power wires through the back of the fixture into the junction box of the fixture.

12. Push the fixture up to close the back wall plate connection and securely attach with thumbscrew.

13. Close the fixture taking care to ensure all wires are inside junction box. Push the fixture upward to compress the gasket and install the ¼ x 20 black nylon thumbscrew and tighten.

#### D. ADJUSTABLE WALL PACK MOUNT



#### Installation instructions for mounting adjustable bracket to LED Hybrid Fixture.

1. Drill two ¼" holes in driver box on both sides of the center line. Center point of drill location is the top of the lines.

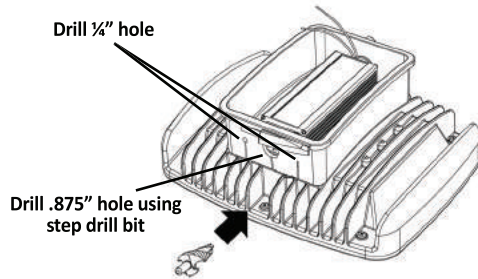

2. Drill a .875" hole using a **step drill bit** or unibit using the top of the center line as a drill center point.

3. Assemble the adjustable bracket onto the fixture driver box with the (2) supplied ¼ x 20 bolts. Secure bolts on inside of driver box using supplied washers and nylon locking nut. Secure supplied cable gland onto driver box tightly.

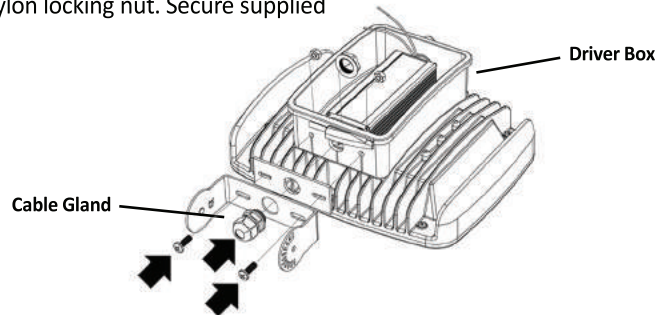

4. Continue to steps below to mount fixture to wall surface.

**NOTE: If replacing existing wall pack and optional wall pack cover plate is NOT used, proceed to Step 8.**

5. Position optional cover plate to cover footprint from original removed wall pack and determine mounting holes and drill for mounting hardware (not supplied). Make sure the mounting plate hole locations are drilled to a strong support of the building to support the weight of the fixture. Drill large hole using step drill in center area of plastic optional mounting cover plate to allow access to wires.

6. Connect building power wires with supplied power cord and secure with wire nuts.

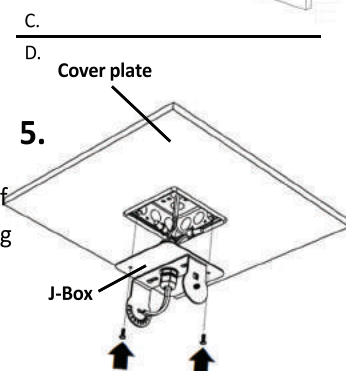
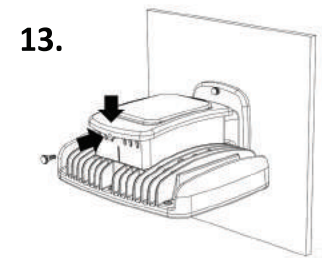
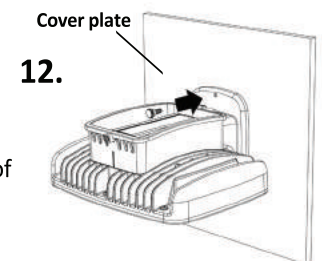
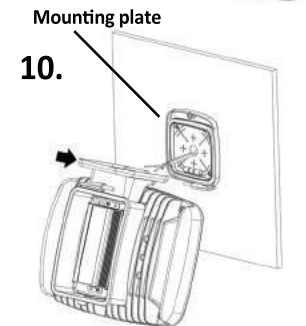
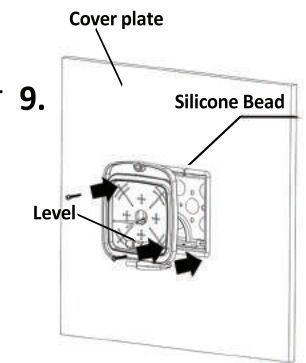



7. Remove outer swivel metal bracket from the fixture by removing two nuts and lock washers and align bracket on optional mounting plate hole and mark two holes making sure the bracket is parallel to the top and bottom edges of the mounting plate. Drill holes in mounting bracket using desired hardware (not included). The slot holes will allow for ¼" hardware.

8. If mounting to a wall junction box, remove outer swivel metal bracket from the fixture by removing two nuts and lock washers. Install bracket onto supplied mounting plate with supplied gasket and hardware (not supplied).

9. Mount supplied cable gland onto bracket and feed the wire through the cable gland. Tighten cable gland securely to seal cord. Apply watertight silicone caulking to the back of the mounting plate to completely seal the mounting plate where it meets the building surface and mount the plate to the building using hardware.

10. Re-assemble fixture to the metal bracket and position at desired angle and tighten with lock washers and ¼ x 20 nut.

11. Remove the thumbscrew from the top lid of the fixture junction box and swing open lid. Feed power cable through cable gland on back of junction box and connect to the fixture driver AC input wires to black (line), white (neutral), and green (ground) using wires nuts or UL approved wire connectors. Make sure all cable glands are tight for watertight connection.

12. Close the fixture taking care to ensure all wires are inside junction box and the junction box is seated properly on the gasket. Push the fixture upward to compress the gasket and install the ¼" x 20 black nylon thumbscrew and tighten.

## E./F. FLOOD AND TRUNNION MOUNTING

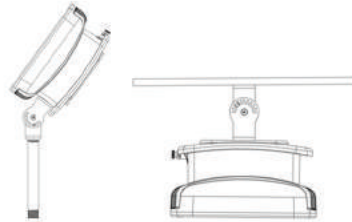

*The trunnion and flood version can be mounted from a ceiling, wall, ground or used with a variety of standard beam clamps and bullhorns to use on poles (supplied by others).*

1. See D1 for Instructions on mounting adjustable bracket to LED Hybrid Fixture to mount bracket to fixture.

2. Remove the outer adjustable bracket and securely mount to desired surface, clamp or adapter depending on mounting application and surface using ¼ x 20 hardware rated for application environment. See Figure 10.

3. Extend power wires into fixture using supplied cable gland. Reference adjustable wall pack instructions above.

4. Mount fixture and complete wiring.

5. **Occupancy Sensor** -- Using a unibit or step drill bit, drill. 875" hole in front of the junction box using the top of the line as the center point. Install and wire sensor per supplied instructions.

7.

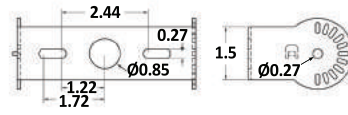

J-Box Lid

8.

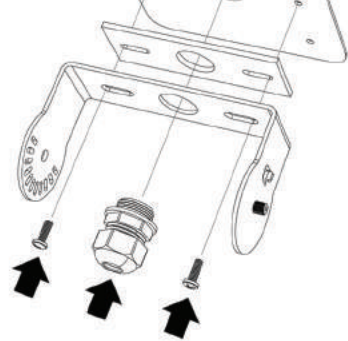

9.

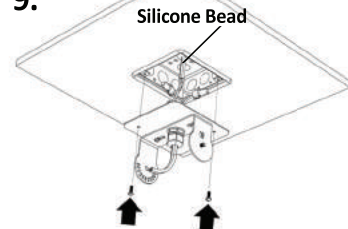

10.

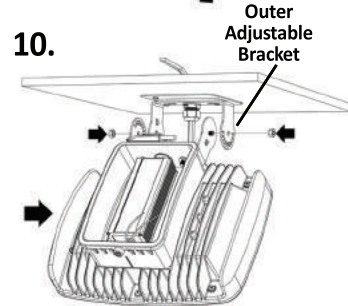

11.

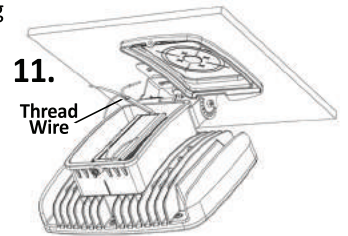

12.

